



NUMBER: 21-019-05 REV. A

GROUP: Transmission

DATE: November 12, 2005

This bulletin is supplied as technical information only and is not an authorization for repair. No part of this publication may be reproduced, stored in a retrieval system, or transmitted, in any form or by any means, electronic, mechanical, photocopying, or otherwise, without written permission of DaimlerChrysler Corporation.

THIS BULLETIN SUPERSEDES TECHNICAL SERVICE BULLETIN 21-019-05, DATED OCTOBER 8, 2005, WHICH SHOULD BE REMOVED FROM YOUR FILES. ALL REVISIONS ARE HIGHLIGHTED WITH **ASTERISKS**** AND INCLUDE AN UPDATED PART NUMBER FOR MOPAR GASKET MAKER.**

SUBJECT:

Transfer Case Shudder

OVERVIEW:

This bulletin involves replacing the planetary assembly cap and changing the transfer case oil.

MODELS:

2005 - 2006 LX/LE 300/Magnum

NOTE: This bulletin applies to LX and LE all wheel drive (AWD) vehicles equipped with a NAG1 transmission (sales code DGJ) built before September 15, 2005 (MDH 0915XX).

SYMPTOM/CONDITION:

Vehicle may experience shudder on slow, parking lot type turns. The friction disc in the transfer case can become clogged with iron particles and may create a stick-slip condition with the pressure plate inside the transfer case.

DIAGNOSIS:

If the vehicle operator describes or experiences the Symptom/Condition, perform the Repair Procedure.

PARTS REQUIRED:

Qty.	Part No.	Description
1	05191126AA	Planetary Assembly Cap
0.6L (1.3 pts.)	05170055AA	Mopar® Transfer Case Lubricant
AR	**04318083**	MOPAR® Gasket Maker

REPAIR PROCEDURE:

1. Raise and support vehicle.
2. Disconnect the front and rear propeller shafts from the transfer case refer to 3 - DIFFERENTIAL & DRIVELINE/PROPELLER SHAFT - REMOVAL. It is not necessary to completely remove the propeller shafts from the vehicle.

NOTE: For the purpose of this procedure, the output shaft flange, output shaft, and rear cover can be removed as an assembly.

3. Remove the bolts holding the transfer case rear cover assembly to the transfer case.
4. Remove the transfer case cover assembly from the transfer case.
5. Remove the snap-ring holding the input shaft to the planetary gear system ([Fig. 1](#)).

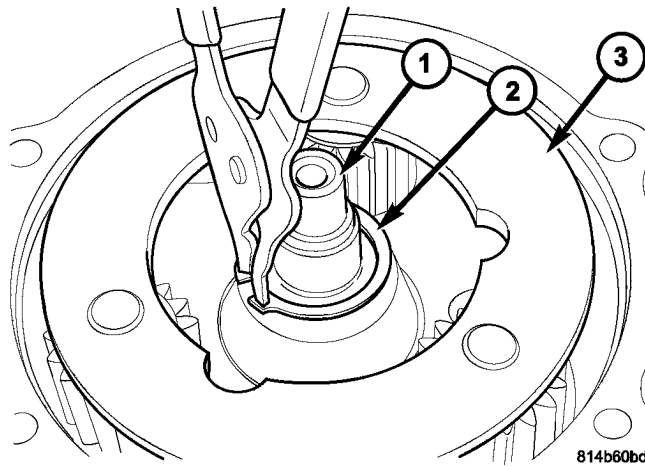

Fig. 1 REMOVE SNAP-RING FROM INPUT SHAFT

- 1 - INPUT SHAFT
- 2 - SNAP-RING
- 3 - PLANETARY GEAR SYSTEM

-
6. Remove the planetary gear system from the transfer case rear housing ([Fig. 2](#)).

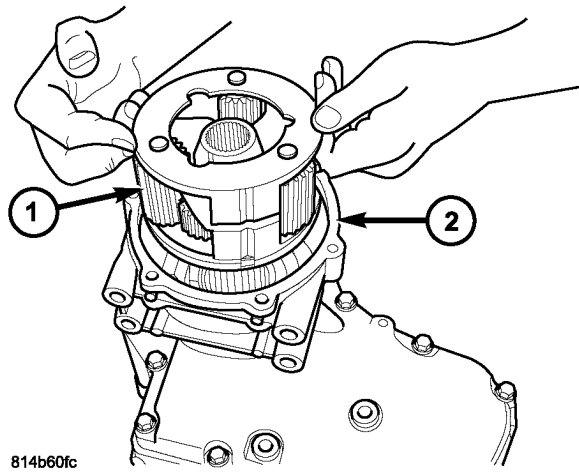

Fig. 2 REMOVE PLANETARY GEAR SYSTEM

- 1 - PLANETARY GEAR SYSTEM
- 2 - REAR HOUSING

7. Remove the bolts holding the planetary cover to the planetary assembly ([Fig. 3](#)).

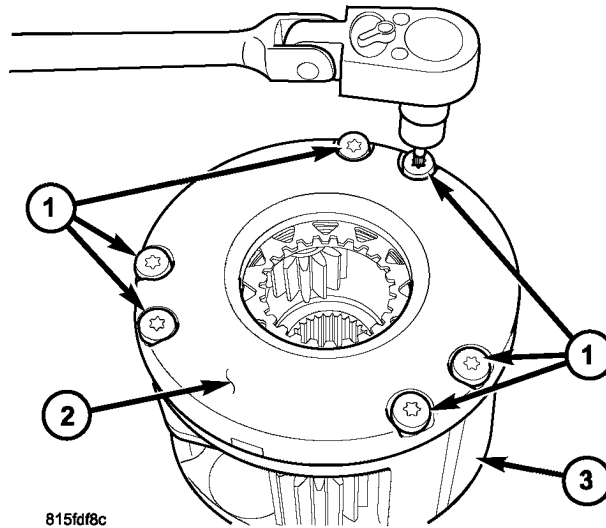

Fig. 3 REMOVE PLANETARY COVER BOLTS

- 1 - BOLTS
- 2 - PLANETARY COVER
- 3 - PLANETARY ASSEMBLY

8. Remove the planetary cover from the planetary assembly ([Fig. 4](#)).

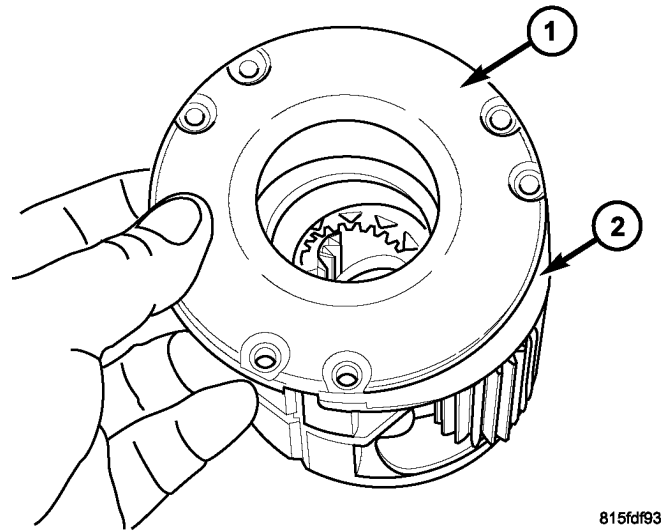

Fig. 4 REMOVE PLANETARY COVER

- 1 - PLANETARY COVER
- 2 - PLANETARY ASSEMBLY

9. Remove the belleville spring from the friction disc apply plate ([Fig. 5](#)).

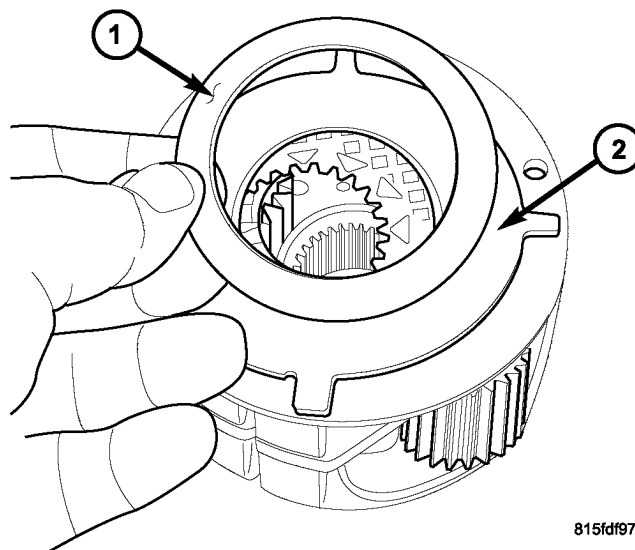

Fig. 5 REMOVE PLANETARY BELLEVILLE SPRING

- 1 - BELLEVILLE SPRING
- 2 - FRICTION DISC APPLY PLATE

10. Remove the friction disc apply plate from the friction disc ([Fig. 6](#)).

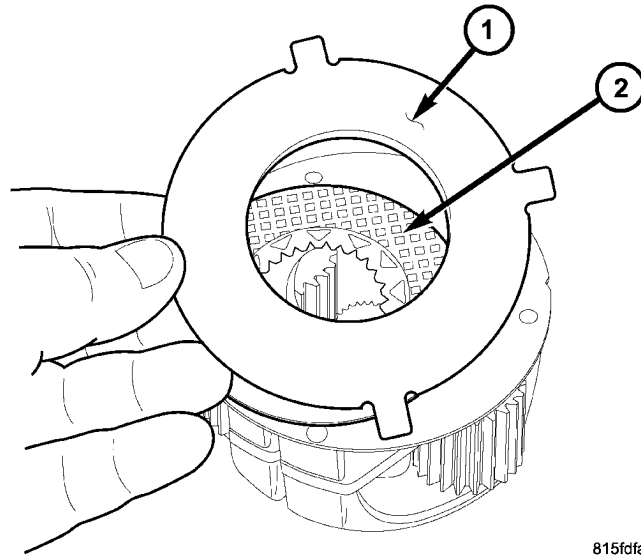

Fig. 6 REMOVE FRICTION DISC APPLY PLATE

1 - FRICTION DISC APPLY PLATE

2 - FRICTION DISC

11. Remove the friction disc from the friction disc washer ([Fig. 7](#)).

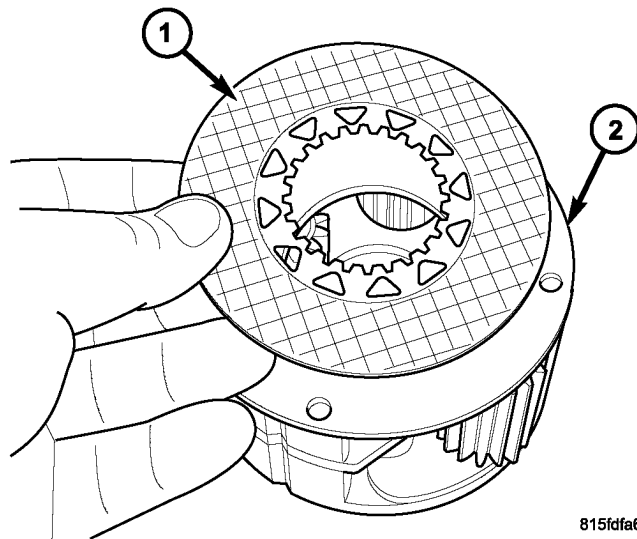

Fig. 7 REMOVE FRICTION DISC

1 - FRICTION DISC

2 - FRICTION DISC WASHER

12. Remove the friction disc washer from the planetary assembly. **Save Friction disc washer for reassembly.**(Fig. 8).

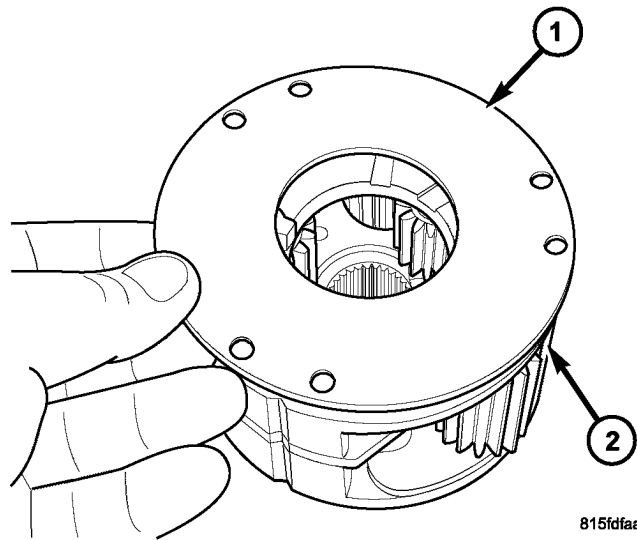

Fig. 8 REMOVE FRICTION DISC WASHER

- 1 - FRICTION DISC WASHER
2 - PLANETARY ASSEMBLY

-
13. Install the new planetary cover and the old friction disc washer onto the planetary assembly (Fig. 4).
14. Install the bolts to hold the planetary cover to the planetary assembly . Tighten the bolts to 9 N·m (6.5 ft.lbs.) (Fig. 3).
15. Install the planetary gear system into the transfer case rear housing (Fig. 2).
16. Install the snap-ring to hold the input shaft to the planetary gear system (Fig. 1).
17. Clean the mating surfaces of the transfer case rear cover assembly and the rear housing.
18. Apply a 2 mm (0.08 in.) bead of MOPAR® Gasket Maker around the perimeter of the rear housing.
19. Position the transfer case rear cover assembly onto the transfer case.
20. Install the bolts to hold the transfer case rear cover assembly to the transfer case. Tighten the bolts in a cross pattern to 34 N·m (25 ft.lbs).
21. Refill the transfer case oil. Refer to the detailed service information available in TechCONNECT, under: Service Info, refer to 21 - Transmission/Transaxle/Transfer Case/Fluid - Standard Procedure.

POLICY:

Reimbursable within the provisions of the warranty.

TIME ALLOWANCE:

Labor Operation No:	Description	Amount
21-03-04-91	Replace Planetary Assembly Cap and refill transfer case oil	1.6 Hrs.

FAILURE CODE:

ZZ	Service Action
----	----------------